

Review 2



Roview2

AUTONOMY:
2 HOURS

4K CAMERA
1080p LIVE VIDEO
FEED

LIGHTWEIGHT: 4KG

WIRELESS
CONNECTION





FLOATABLE



WATERTIGHT HULL

DIMENSIONS:
37 cm L; 30 cm W; 31cm H



Waterproof hull: Suitable for use on land and water.

Obstacle clearance: The weight/tyre area ratio allows it to cross all kinds of deposits.

Autonomy: The rechargeable battery enables an operating time of up to 2 hours with the LEDs switched on or up to 8 hours when the LEDs are switched off.

Roview2

THE TURRET

The Roview2 camera can rotate 360° horizontally and tilt 180° vertically, allowing a complete inspection of the environment. The HMI displays all the information required for ITV reports in accordance with the NF13508-2 standard.

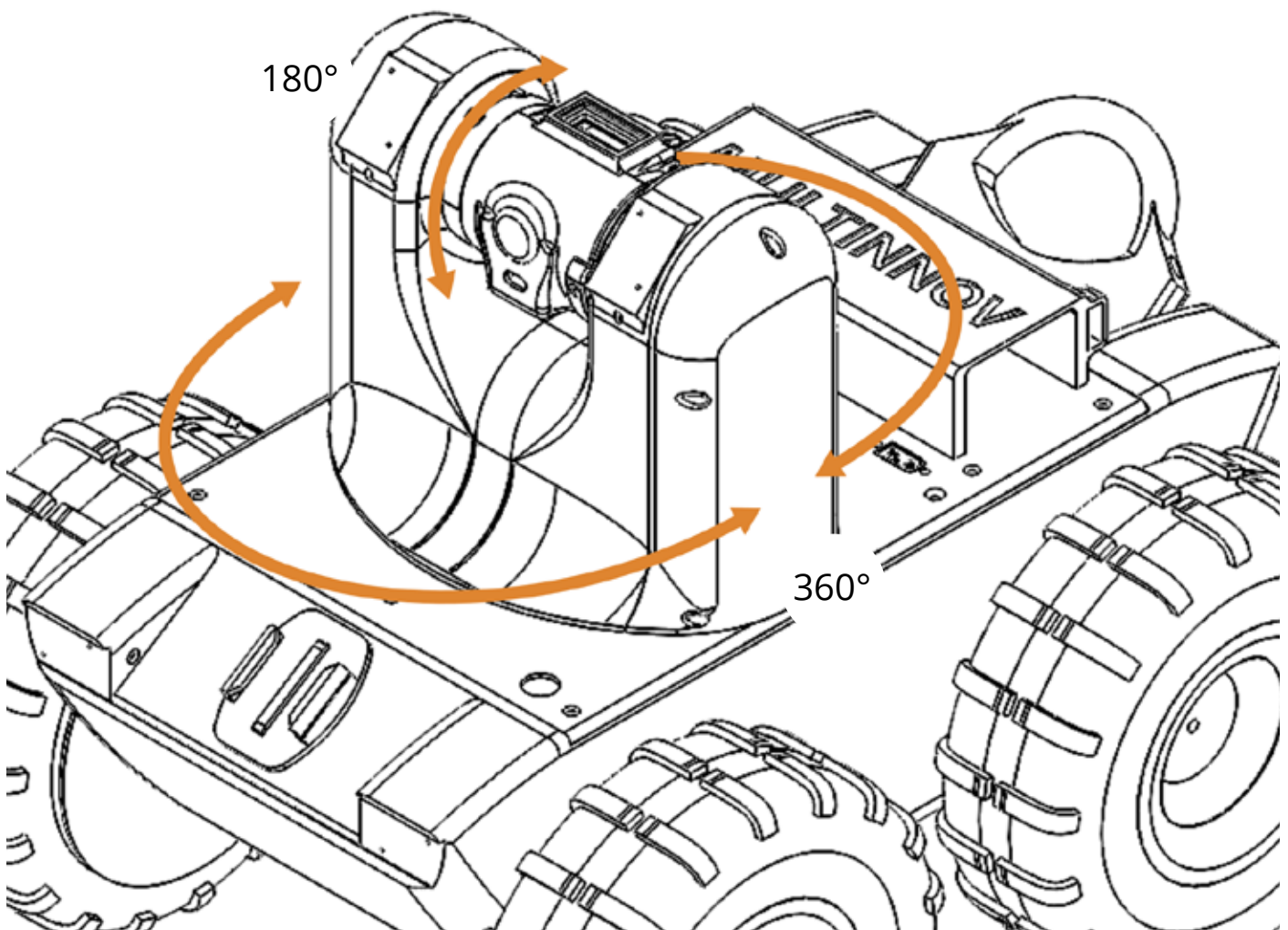

LIGHTING

The Roviev2 is equipped with 6 LED panels that enable it to work in the darkest environments. The LED panels achieve a brightness of up to 10,000 lumens.

ATTACHMENT POINT

Its mounting point (Go-Pro mount) for various sensors (gas sensor, positioning system) allows it to capture data in the best quality for your needs.





DEFECT MEASUREMENT

The crosshair is equipped with a scale that enables defects to be measured directly and in real time. The measurement takes place seamlessly and dynamically during the inspection.

MEASURING THE DISTANCE

Thanks to the coded wheels, the Roviev2 can measure the distance traveled with a maximum error rate of 1%. This precise measurement is essential for the inspection of sewers and compliance with various regulations, such as the NF 13508-2 standard.

RANGE EXTENDER

The range extender enables you to position the transmitting and receiving point to the most convenient location for your inspection. It improves the range even in the most difficult environments and lets the Rovie2 operate up to a depth of 10 meters underground.

OPERATION OF THE RANGE EXTENDER



Remote control



Range extender



Rovie2

Roview2

ON-BOARD ELECTRONICS



CAMERA

4K 30 FPS camera

Automatic ISO setting Auto focus

Micro SD storage, FOV 16:9 sensor

160° 12 MP

Standard lens - no distortion



COMMUNICATION LINK

2.4 GHz video band (ISM)

1080p video stream (FULL HD)

Intuitive touchscreen

Direct line of sight > 2 km CE standard

/ 20 km < FCC standard



Remote Control

2.4 GHz radioband (ISM)

Optional range extender

Telemetry

Long range radio

Roview2

SAFETY FEATURES OF THE ROVIEW

REVERSE

With the press of a button, the Roview2 can intuitively reverse, allowing it to navigate effortlessly through pipes in both directions while keeping cohesive telemetry data for your inspection.

STABLE MACHINE

Its 30° tilt warning, telemetric feedback and stability enable a safe and high-quality inspection. It is stable up to an angle of 45°.





ACCESSORIES

BASIC PACKAGE



TRANSPORT CASE



FAST CHARGERS FOR BATTERIES AND
REMOTE CONTROL



3 BATTERIES



REMOTE CONTROL WITH DISPLAY



ROVIEW2

OPTIONAL



ADDITIONAL SCREEN



ADDITIONAL BATTERY



RANGE EXTENDER

Roview2

TECHNICAL SPECIFICATIONS

CRAWLER

Configuration	Fixed wheels - differential rotation
Engines	4 motors - 100 rpm
Autonomy	2 h driving + LEDs on 5 h LEDs off 8 h standstill
Weight	4 kg
Dimensions	37 / 30 / 31 cm L.W.H.
Materials	SLA resin ("shell") - Nylon (other parts) - SLS
Operating temperatures	-20°C to +40°C
Safety	Rollover warning from 30° Failsafe : Vehicle stop
Operating frequencies	2400 to 2483 MHz
EMC	2,4 GHz 20 dBm (CE) 23 dBm (FCC)
Class of protection	Splash and dust resistant camera Waterproof housing

LIGHTING SYSTEM

Total output	10 000 lumens
Output per panel	1666 lumens

CAMERA

Sensor	4K, Sony IMX117 1/2.3 inch 12 MP
Video format	MP4
Photo format	JPG
Max. Video resolution	3840/2160 - 30 FPS (4k)
Video streaming resolution	1920/1080 - 30 FPS (HD)
Photo resolution	3840/2160 (4K)
FOV	110° diagonal 90° horizontal
Lens	2.1 mm - hard focus
ISO	Automatic management
Saving files	Micro SD card (on board the drone) Class 10 or higher
Supported SD cards	32 - 64 GB (recommended capacities)
Supported format	FAT 32

BATTERY

Capacity	5000 mAh
Type	LiPo
Nominal voltage	14.8 V (4S)
Energy	74 WH
Charging time	approx. 1 hour (1C)
Weight	480 g - 1.05 lbs
Operating temperatures	-20°C to 40°C

REMOTE CONTROL UNIT

Operating frequencies	2400 to 2483 MHz
Standards	CE/SRRC/FCC/MIC
Optional standard	IN84 (CNPE emissions <50 mW)
EMC	2.4 GHz / 23 dBm (FCC) 23 dBm (FCC)
Radio connection	Duplex
Outdoor range	12 km (CE) 20 km (FCC)
Range in confined spaces	Up to 400m
Dimensions	22 / 10.5 / 3.5 cm (without antennas)
Display size	5.46 inches, 16 million colors, touchscreen
Weight	520 g
Operating temperature	-20°C to +40°C
Battery	LiPo 4950 mAh USB charging
Receiver sensitivity	-120 dBm
Antennas	1 omnidirectional 1 directional

TRANSPORT CASE

Dimensions	67 / 50 / 38 cm
Weight	16 kg (basic package)
Compliance	Complies with IATA regulations Size/weight compatible with check-in baggage



CONTACT

viZaar North
Sales and Service Office
 25361 Krempe
 Mobile: +49 171 5524094

viZaar North Germany
VT Service / Rental Service / Sales
 29339 Wathlingen
 Mobile: +49 160 93777644

viZaar NRW
Sales and Service Office
 46348 Raesfeld
 Mobile: +49 170 5703130

viZaar industrial imaging AG
VT Service / Rental Service / Sales /
Training Center
 Lupusstraße 17
 35789 Weilmünster / Germany
 Fon: +49 6475 91129-0
 Fax: +49 6475 91129-29
xtra@vizaar.de
www.vizaar-xtra.de

viZaar industrial imaging AG
Headquarter
 Hechinger Straße 152
 72461 Albstadt / Germany
 Fon: +49 (0) 74 32 / 98 37 5-5
 Fax: +49 (0) 74 32 / 98 37 5-50
 Freecall 0800 3600371
 (within Germany)
info@vizaar.com
www.vizaar.de

viZaar South
Sales and Service Office
 88161 Lindenberg im Allgäu
 Mobile: +49 172 6019 601

